

DUPLEX UNIT
(Machine Code: G303)

1. REPLACEMENT AND ADJUSTMENT

⚠ CAUTION
 Turn off the main power switch and unplug the machine before beginning any of the procedures in this section.

NOTE: This manual uses the following symbols.

☛ : See or Refer to 🔩 : Screws 📡 : Connector

1.1 EXTERIOR COVER

1. Exterior cover [A] (🔩 x 4)

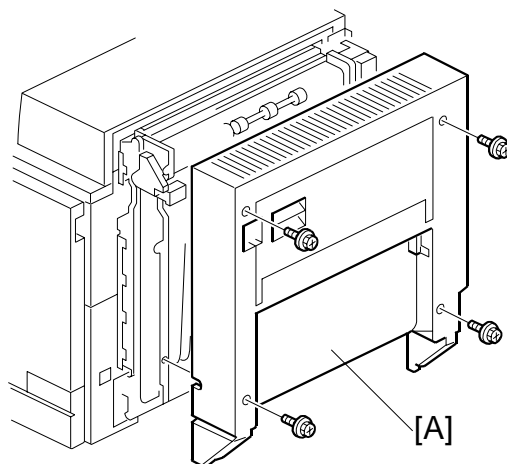

G303R101.WMF

1.2 ENTRANCE/EXIT SENSORS

1. Exterior cover (☛ 1.1)

Entrance Sensor

2. Sensor bracket [A] (🔩 x 1)
3. Feed sensor [B] (📡 x 1, 🔩 x 1)

Exit Sensor

4. Exit sensor [C] (📡 x 1)

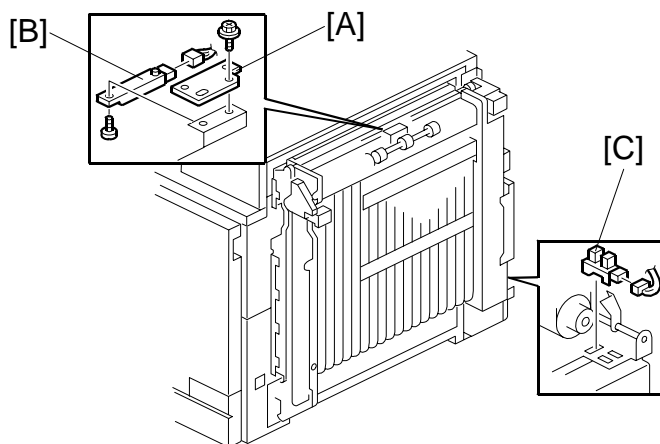

G303R102.WMF

Peripherals

1.3 INVERTER MOTOR

1. Exterior cover (☛ 1.1)
2. Inverter motor [A] (☛ x 1, ⚙ x 3)

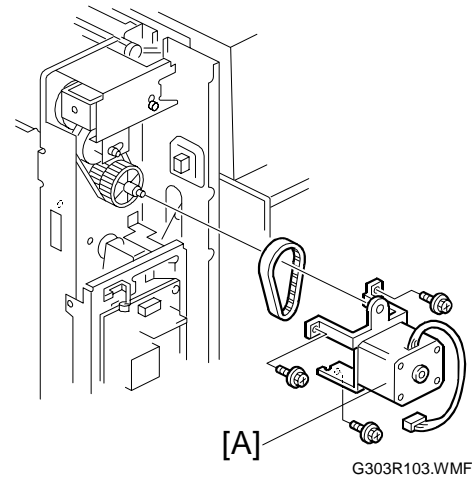

1.4 CONTROLLER BOARD

1. Exterior cover (☛ 1.1)
2. Controller board [A] (☛ x 5, ⚙ x 3)

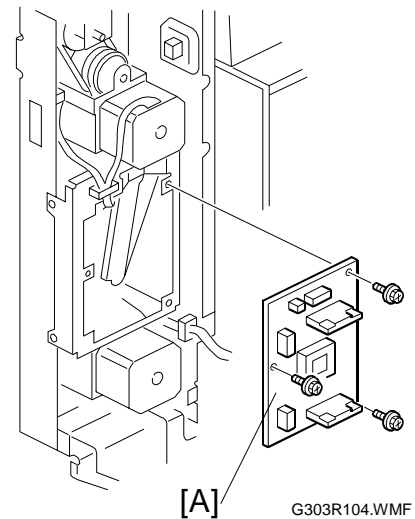

1.5 TRANSPORT MOTOR

1. Exterior cover (☛ 1.1)
2. Controller board (☛ 1.4)
3. Transport motor (1 spring, ☛ x 1, ⚙ x 2)

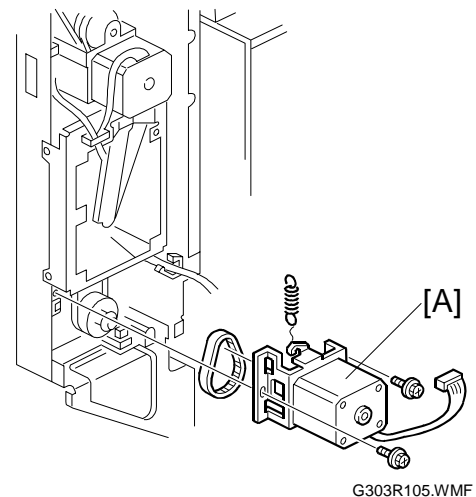

2. DETAILED DESCRIPTIONS

2.1 OVERVIEW

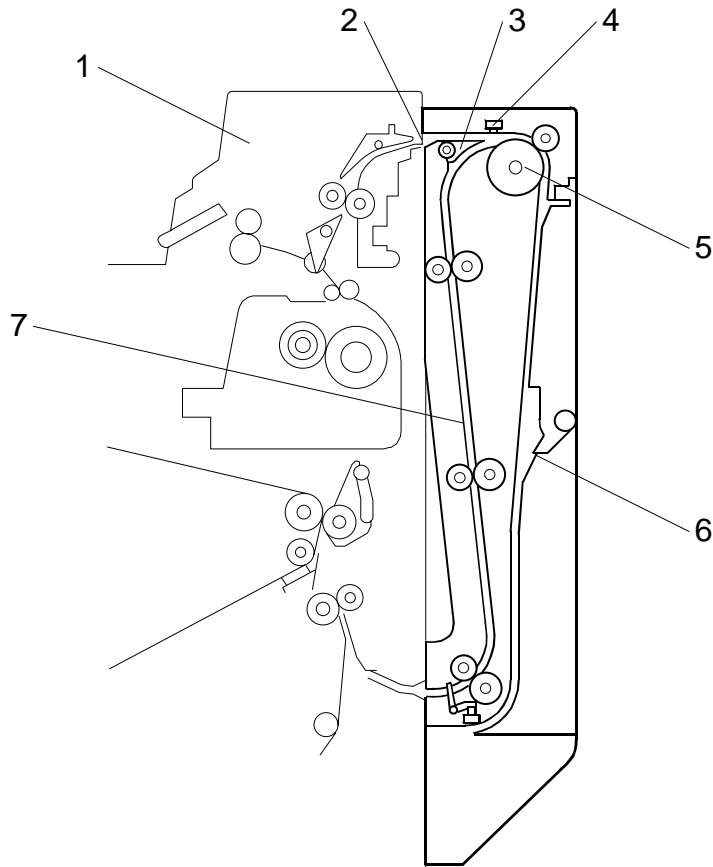

G303D101.WMF

- | | |
|---------------------|---------------------|
| 1. Interchange unit | 5. Inverter roller |
| 2. Paper entrance | 6. Inverter section |
| 3. Inverter gate | 7. Paper exit path |
| 4. Entrance sensor | |

Peripherals

2.2 ELECTRICAL COMPONENT LAYOUT

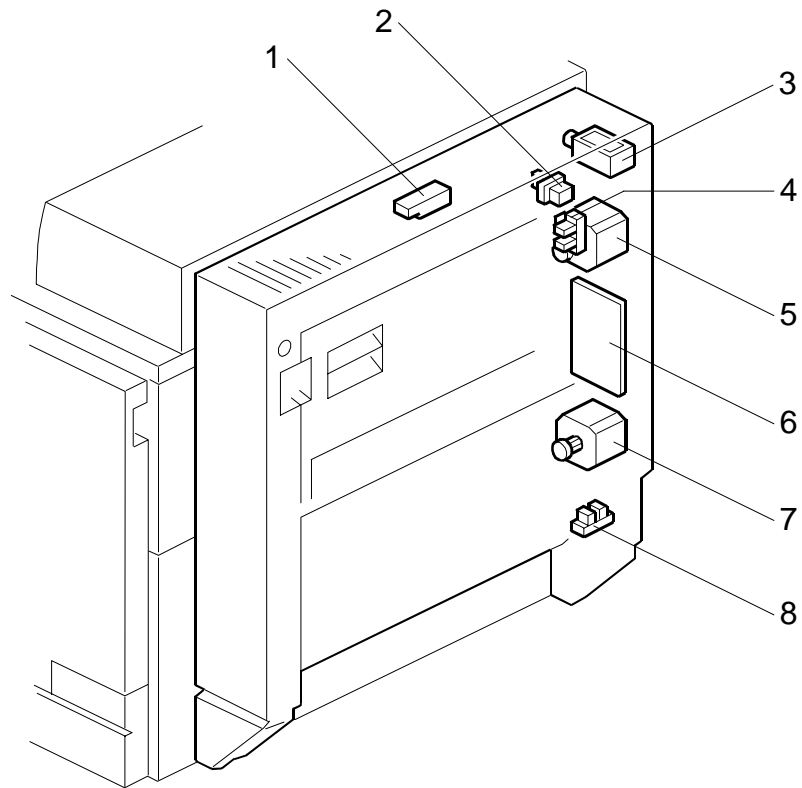

G303D102.WMF

- | | |
|----------------------------|---------------------|
| 1. Entrance sensor | 5. Inverter motor |
| 2. Duplex unit open switch | 6. Controller board |
| 3. Inverter gate solenoid | 7. Transport motor |
| 4. Cover sensor | 8. Exit sensor |

2.3 DRIVE LAYOUT

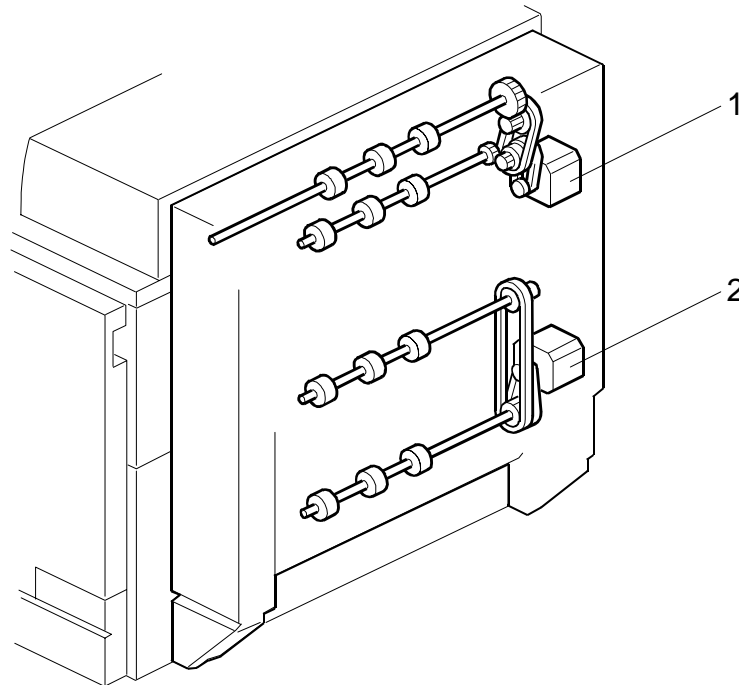

G303D103.WMF

1. Inverter motor
2. Transport motor

2.4 DUPLEX PAPER FEED ORDER

2.4.1 LONGER THAN A4/LT LEF

The feed path through the duplex unit can only hold one sheet of paper.

Example: 8 pages. The number [A] in the illustration shows the order of pages. The number [B] in the illustration shows the order of sheets of paper (if shaded, this indicates the second side).

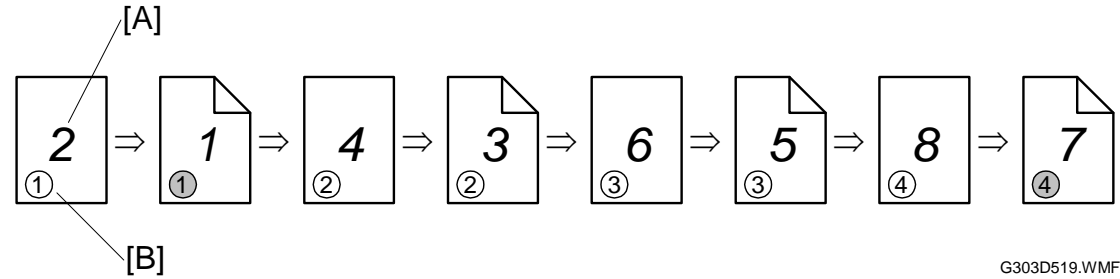

G303D519.WMF

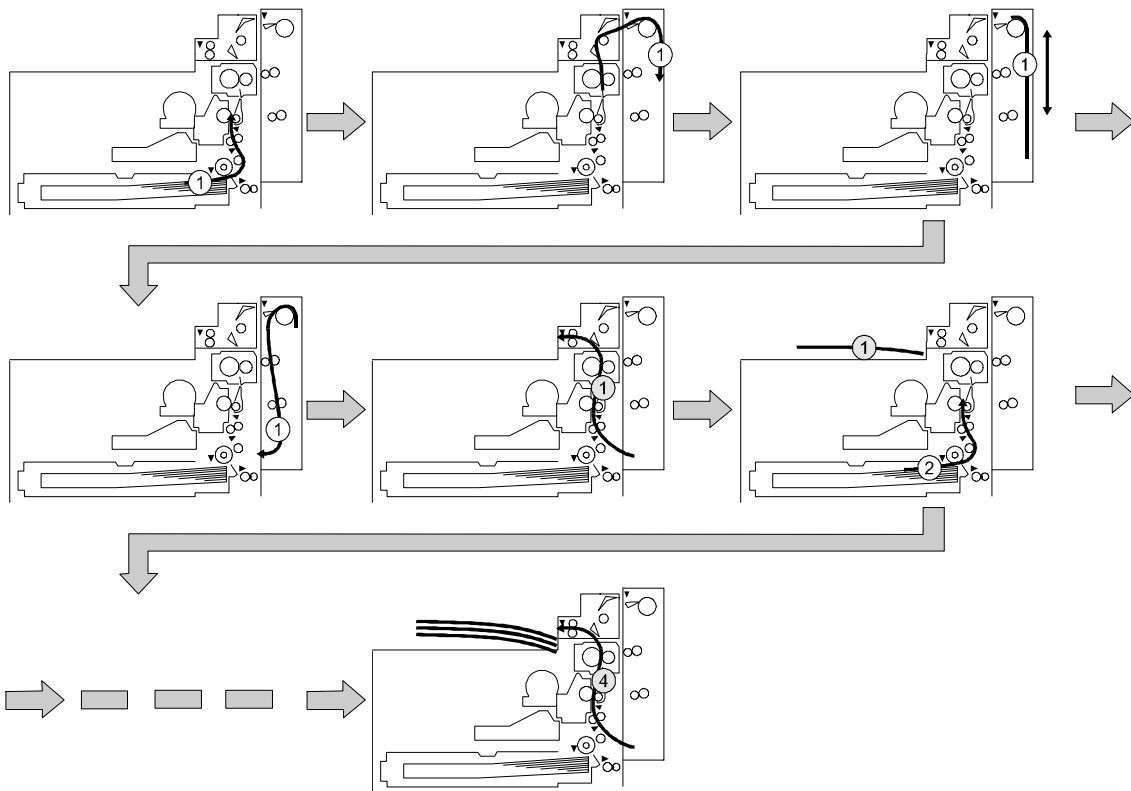

G303D518.WMF

2.4.2 UP TO A4/LT LEF

The feed path through the duplex unit can hold 2 sheets of paper

Example: 8 pages. The number [A] in the illustration shows the order of pages. The number [B] in the illustration shows the order of sheets of print paper (if shaded, this indicates the second side).

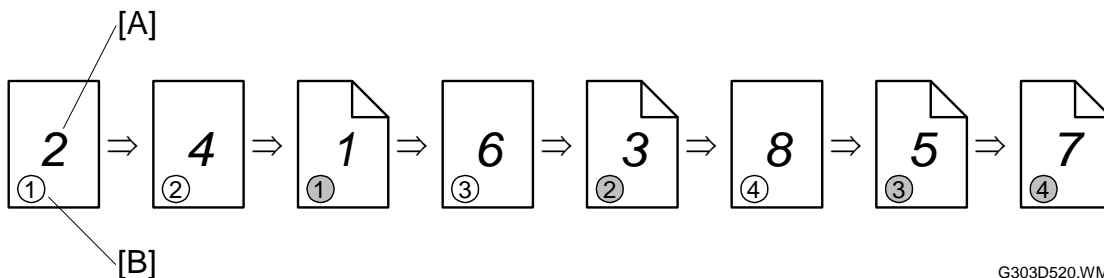

G303D520.WMF

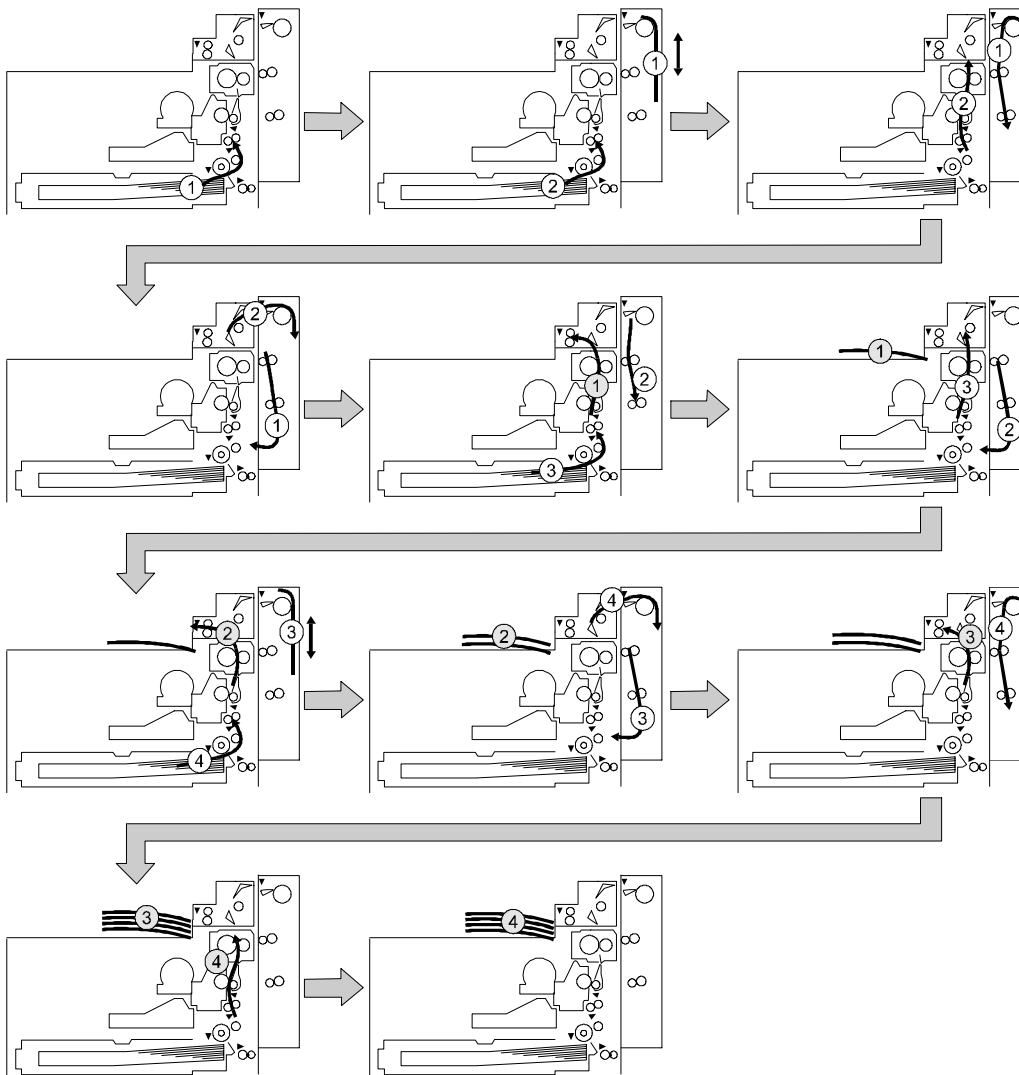

G303D517.WMF

Peripherals

2.5 REVERSE MECHANISM

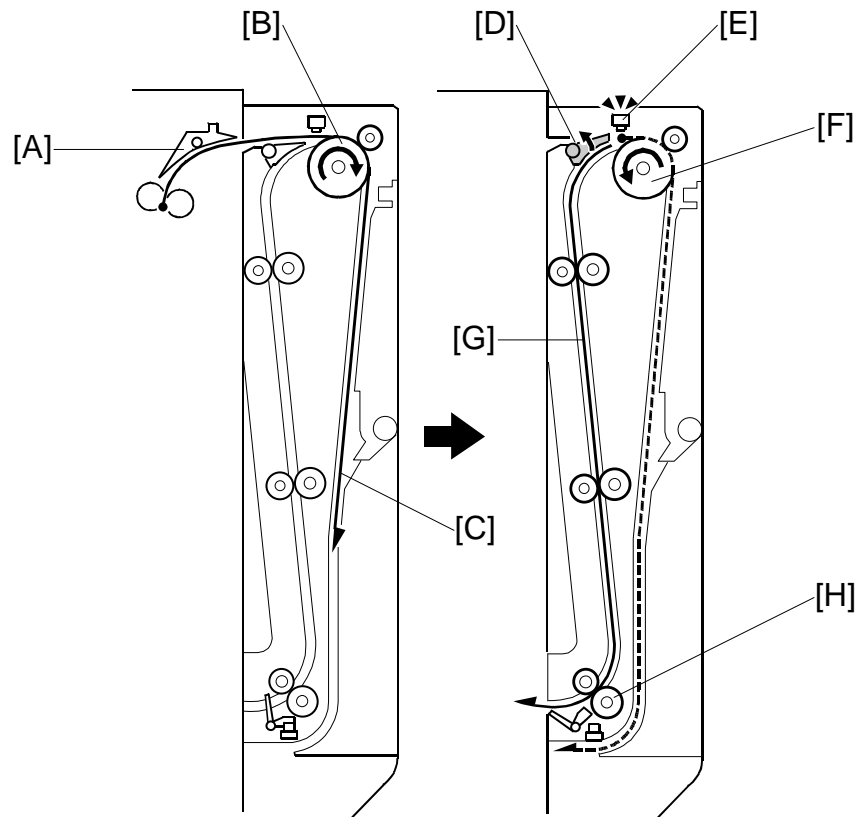

G303D104.WMF

The duplex unit starts when the entrance sensor [E] detects paper coming in.

1. **Interchange unit gate [A]**
Directs the paper to the duplex unit (up to A3 SEF)
2. **Inverter roller [B]**
Sends the paper to the inverter section [C]
3. **Entrance sensor [E]**
Detects the trailing edge of the paper
4. **Inverter gate solenoid (behind [D])**
Activates the inverter gate [D]
5. **Inverter gate [D]**
Switches the paper path
6. **Inverter roller [F]**
Changes its rotation direction (sends the paper to the exit path [G])
7. **Transport roller [H]**
Sends the paper to the main unit registration roller